

REFERENCE NOTE:

This drawing is to be read in conjunction with drawings and supporting documentation produced by the following consultants:-

- R ELLIOTT ASSOCIATES LTD.
- LINDSAY CARRINGTON ECOLOGICAL SERVICES LTD.
- SOUTHERN ENERGY CONSULTANTS LTD.
- T.P. MARSH ARBORICULTURAL CONSULTANT
- ANNA LONGLEY LANDSCAPE ARCHITECT

Roof construction to comprise plain roof tiling on T.S.M. battens and counter battens (sized as per the manufacturers specification) on breathable roofing underlay on trussed / cut timber roof. Refer to Construction Notes and Consultant Engineers details and specification.

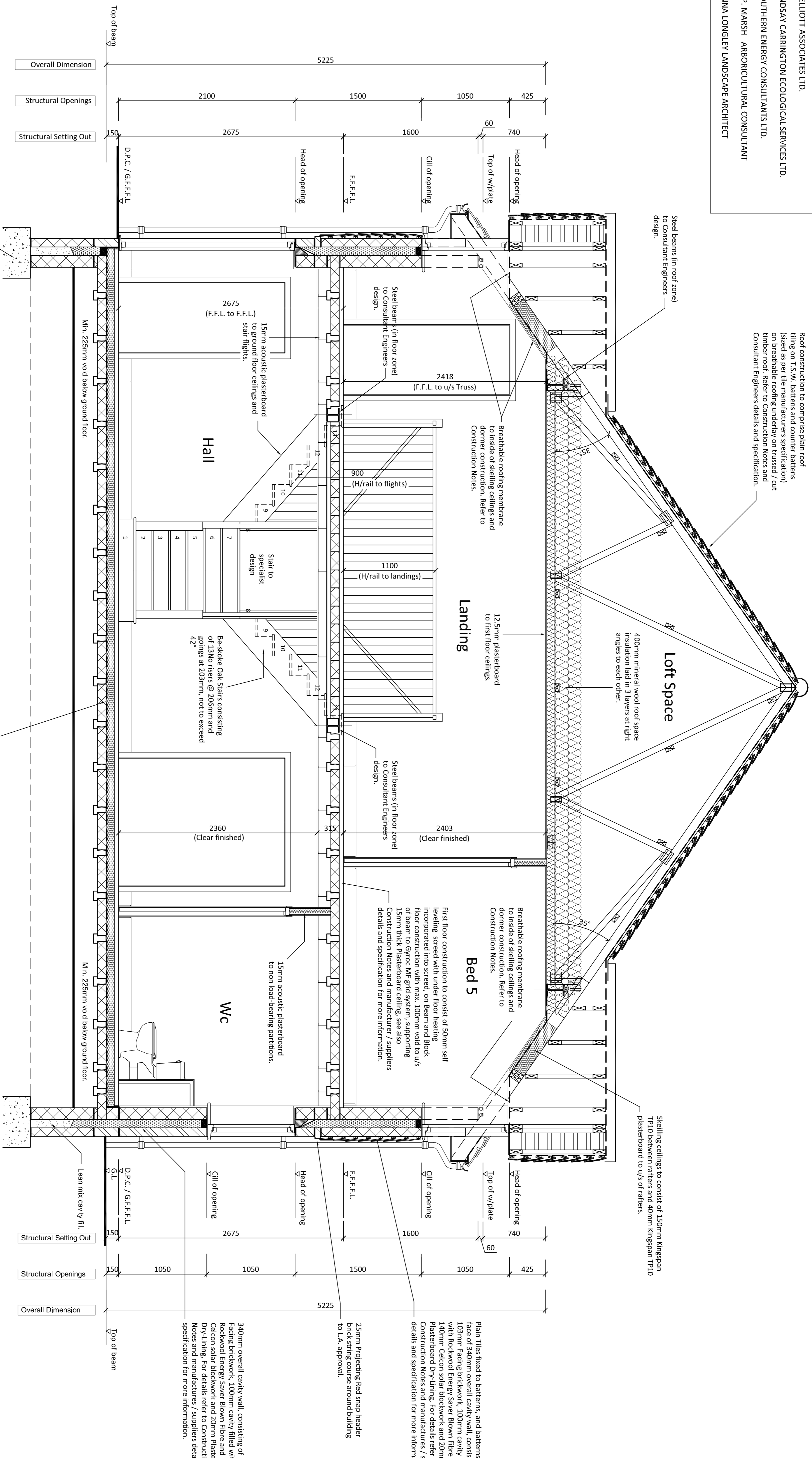

Section 1A-1A
Scale 1:25

KEY TO INSULATION:

- Blown fibre full cavity fill insulation (refer to Project Construction Notes)
- Mineral wool roll insulation (refer to Project Construction Notes)
- PIR insulation board (refer to Project Construction Notes)

For details of foundations refer to Consultant Engineers drawings and specification.

Ground floor construction to consist of 50mm self leveling screed with under floor heating incorporated into screed, on 100mm thick Kingspan Kooltherm K3 insulation on 1200th gauge dim on Beam and Block floor construction, see also Construction Notes and manufacturer / suppliers details and specification for more information.

340mm overall cavity wall, consisting of 1 Facing brickwork, 100mm cavity filled with Rockwool Energy Saver Blown Fibre and 1 Celcon solar blockwork and 20mm Plaster Dry-Lining. For details refer to Construct Notes and manufacturers / suppliers detail specification for more information.

IMPORTANT NOTE:

Accurate setting out of buildings on (an in relation to) site is critical. For setting out details refer to Consultant Engineers drawings.

NOTE:

Light switches and door bell switch to be 1200mm above F.F.L. All other electrical sockets to be 450mm above F.F.L. (unless stated otherwise).

NOTE:

Construction work to follow the instructions and guidance of the Accredited Construction Details for Part L - June 2007 1st Edition for the purpose of achieving insulation continuity and air tightness.

1. This drawing is the copyright of ABC Designs Ltd. It may not be copied, altered or reproduced in any way whatsoever, neither passed to a third party without their written authority.
2. Dimensions to be checked on site prior to commencing any work. Any discrepancies should be reported to the project designer immediately.
3. Please do not scale these drawings.
4. If in doubt ask.

GENERAL NOTES:

1. For details and specifications of all elements illustrated on this drawing refer to Project Construction Notes ensuring latest revision at all times.
2. This drawing is to be read in conjunction with all relevant Consultant Engineer and sub-contractor drawings, schedules and specifications ensuring latest revision at all times.
3. All dimensions shown are to structural elements (not to finishes) unless stated otherwise. For clear internal dimensions subtract finishes from overall dimension. Refer to Project Construction Notes for finishes to each wall condition.
4. All dimensions to be checked on site prior to commencing any work. Any discrepancies should be reported to the Project Architect immediately.
5. If in doubt ask.

KEY TO WALLS:

- 102mm Face brickwork (to Local Planning Authority approval).
- 100mm Aircrete insulating blockwork (block strengths as specified by Consultant Engineer).
- 140mm Aircrete insulating blockwork (block strengths as specified by Consultant Engineer).
- 70mm metal C studwork partition.
- MJ Movement joint positions (from Doc level upwards). Refer also to Consultant Engineers details.
- A.b Sub-ground floor ventilation air brick positions complete with telescopic ventilation ducts (positioned at max. 1.8m centres).

| Rev. | Description | Building Regulations Issue | Date | By | Ch |
|------|-------------|----------------------------|----------|------|------|
| A | DESCRIPTION | Building Regulations Issue | 31.03.10 | W.M. | M.C. |
| B | REVISION | REVISION | 07.09.10 | W.M. | M.C. |
| C | REVISION | REVISION | 07.10.10 | W.M. | M.C. |
| D | REVISION | REVISION | 07.10.10 | W.M. | M.C. |



Client: **M/F M Morris**

Project: **New Dwelling 'The Cottage' Bakers Drive, Rownhams, Hampshire.**

Drawing: **Section 1A-1A**

| Drawn | Scale | Checked | Date |
|-------------|-----------|---------|----------|
| W.M./M.C. | 1:25 @ A1 | MC | Mar10 |
| Drawing no. | Scale | Checked | Date |
| 0910-WD08 | 1:25 @ A1 | MC | Mar10 |
| | | | Revision |
| | | | D |